

# TRANSFORMERS PRIME™

## HOT SHOT®

AUTOBOT®

NOTE: Some parts are made to detach if excessive force is applied, and are designed to be reattached if separation occurs. Adult supervision may be necessary for younger children.



**WARNING:**

CHOKING HAZARD—Small parts.  
Not for children under 3 years.

**AGES 5+**

98738/37975 ASST.

INTERMEDIATE LEVEL  
1 2 3

### CHANGING TO ROBOT

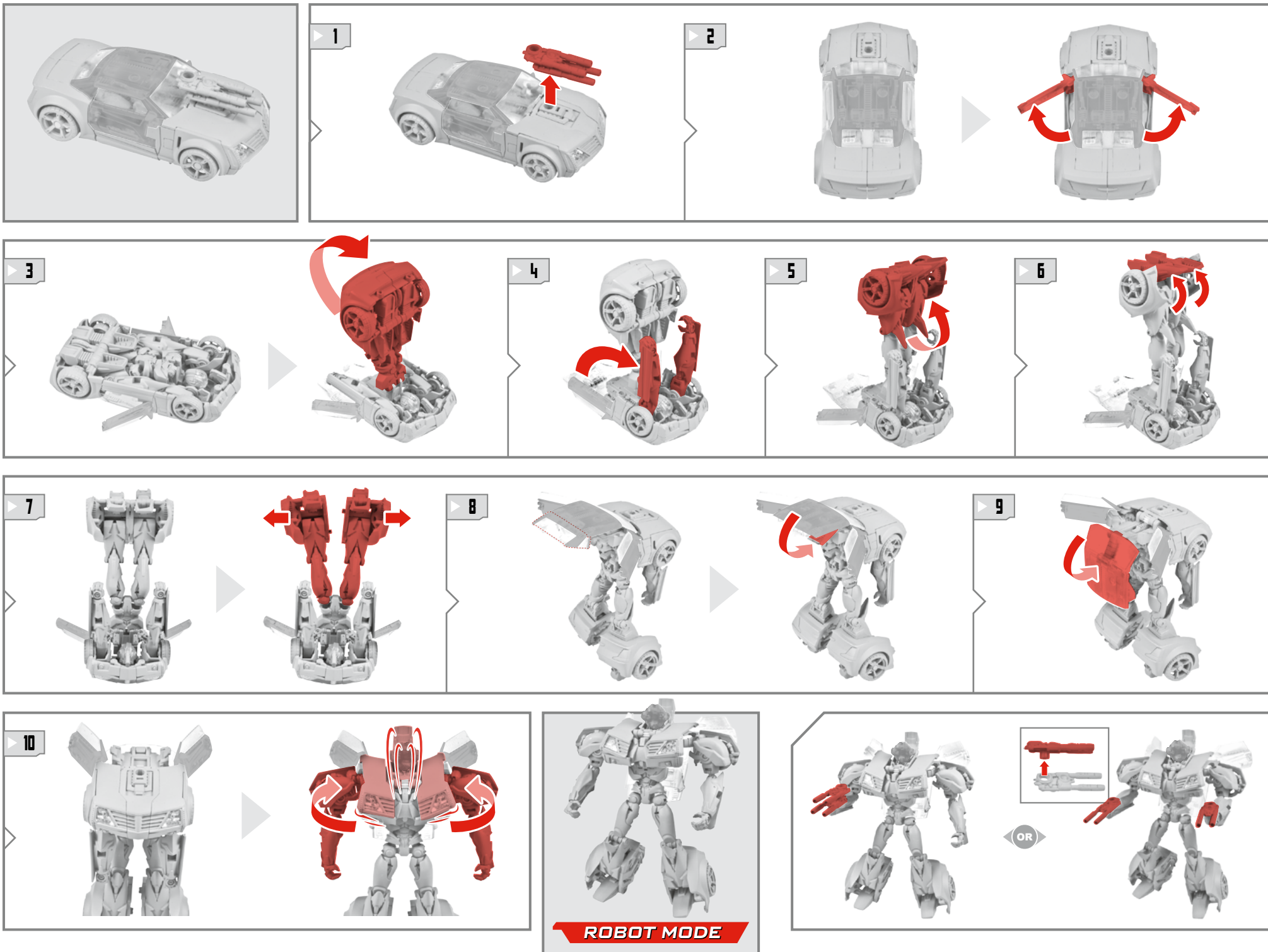

# CHANGING TO VEHICLE

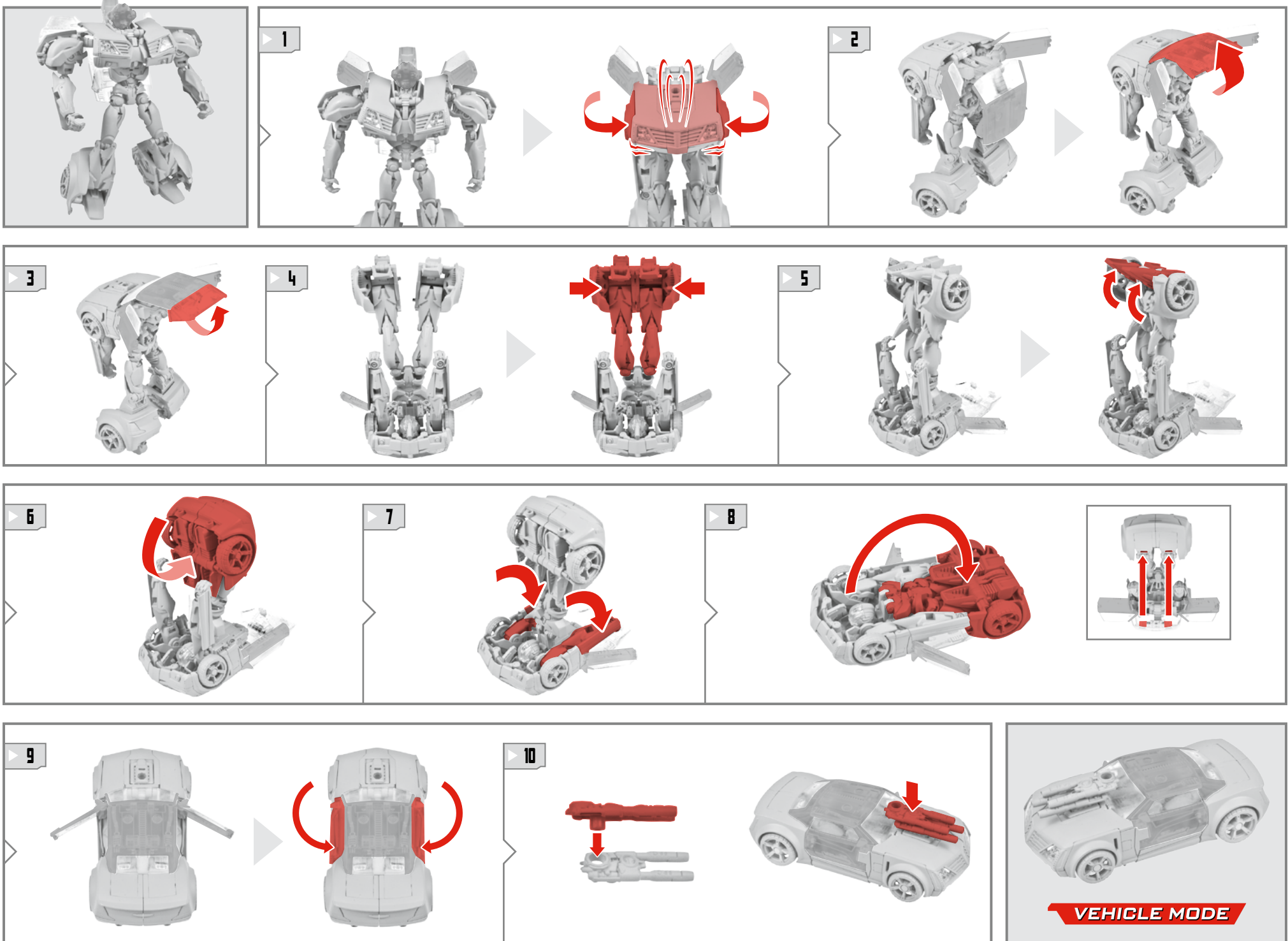

Retain instructions for future reference.

Product and colors may vary. Some poses may require hand support.  
Manufactured under license from TOMY Company, Ltd.  
© 2011 Hasbro. All Rights Reserved. TM & © denote U.S. Trademarks.

P/N 725410000

[TRANSFORMERS.COM/INSTRUCTIONS](http://TRANSFORMERS.COM/INSTRUCTIONS)

